

#14 Stainless

#14, 13 tpi, drill point

For the attachment of insulation and membrane roof covers in a corrosive environment



- 400 series stainless steel is a magnetic heat-treatable stainless steel.

- Type 410 self-drilling fasteners provide fair resistance to corrosion in mild to light industrial environments.

Application

Dekfast #14 Stainless Steel

Attachment of insulation and/or roof covers in mild to light industrial environments

Materials:

- Steel thickness from 22 ga (.028 in.) through 18 ga (.045 in.):
Min penetration: 3/4"
- Plywood: Min thickness: 3/4"
- FR treated: Min penetration: 1/4"
- Wood 2x: (1-1/2" thick):
Min penetration 1"

Use with:

- Stress plates
- Batten Bar
- Other attachment elements approved by the roofing system manufacturer for use with its products

Steel roof decks include all FM approved 18-20-22 ga

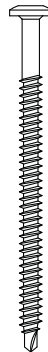
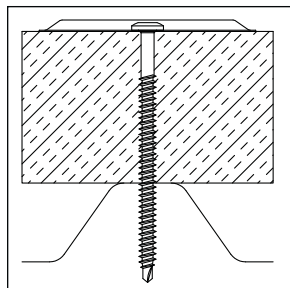

Head: #3 Phillips Truss head
Head Height: .118" max
Head Dia: .440" max
Thread Major Dia: .235"
Shank Dia: .180"

Pull-out: (lbs avg.):

- 24 ga: 325
- 22 ga: 470
- 20 ga: 635
- 18 ga: 815
- Plywood (3/4" thick): 495

Notes

Dimensions are nominal inches unless noted. The specific job conditions should be considered and appropriate safety factors applied when specifying the proper fasteners.

Selection

Fastener Length	*Thread Length	Material No.	North American Code	Steel	Wood	Concrete	Carton Wt. (lbs)	Carton Qty.	Skid Qty.
1-1/2"	Full	791371	DF-S4-#14x1-1/2-PH3-B	Up to 3/4"	Up to 1/2"	Up to 1/2"	14	1,000	60,000
2"	Full	791373	DF-S4-#14x2-PH3-B	Up to 1-1/4"	Up to 1"	1/2" to 1"	18	1,000	60,000
3"	2.875"	791376	DF-S4-#14x3-PH3-B	3/8" to 2-1/4"	Up to 2"	1-1/2" to 2"	25	1,000	40,000
4"	3.875"	791379	DF-S4-#14x4-PH3-B	3/8" to 3-1/4"	Up to 3"	2-1/2" to 3"	32	1,000	40,000
5"	3.875"	791381	DF-S4-#14x5-PH3-B	1-3/8" to 4-1/4"	1-3/8" to 4"	3-1/2" to 4"	39	1,000	40,000
6"	3.875"	791383	DF-S4-#14x6-PH3-B	2-3/8" to 5-1/4"	2-3/8" to 5"	4-1/2" to 5"	46	1,000	40,000
7"	3.875"	791385	DF-S4-#14x7-PH3-B	3-3/8" to 6-1/4"	3-3/8" to 6"	5-1/2" to 6"	27	500	30,000
8"	3.875"	791387	DF-S4-#14x8-PH3-B	4-3/8" to 7-1/4"	4-3/8" to 7"	6-1/2" to 7"	30	500	30,000
10"	3.875"	791389	DF-S4-#14x10-PH3-B	6-3/8" to 9-1/4"	6-3/8" to 9"	8-1/2" to 9"	39	250	20,000
12"	3.875"	1298264	DF-S4-#14x12-PH3-B	8-3/8" to 11-1/4"	8-3/8" to 11"	10-1/2" to 11"	48	250	20,000

* Note - Thread length measured from tip of the drill point to end of threads.

Approvals

Dekfast fasteners and plates are Factory Mutual approved for attachment of insulation board and/or roof cover to roof deck. Refer to FM Approval Guide and Supplements for current FM approved insulation fastening patterns. Dekfast stainless fasteners meet Factory Mutual corrosion-resistance Standard 4470.

Installation

Tools: 2000–2500 rpm screw guns and #3 hardened Phillips bit.

The standard carton package includes one #3 Phillips bit.

Options

Dekfast stainless fasteners must be used with the following plates or other attachment elements approved by the roofing systems manufacturer for use with their products: 3" round plastic plate (792622).

